



Shanghai Solar Energy S&T Co.,Ltd.

About Shanghai Solar Energy S&T Co.,Ltd.

Officially registered in January 2000, Shanghai Solar Energy S&T Co.,Ltd.

The company has built more than 300 photovoltaic power stations.

Space Photovoltaic Industry Chain

As an important unit of Space photovoltaic industry chain,
relying on aerospace technology advantage.

Competitive Strength

SSEC has abundant experience in photovoltaic production
It has researched and developed large area high-power BIPV modules.

Features

- Unique design of the aluminum alloy frame
 - Complete & Compact seal design
 - High light transmission glass
- These details to ensure the high quality of our products.

Corporate Culture

Integrity , Innovation , Harmony.

Warranties

- 5-year limited product warranty*
- Limited power warranty*: 10 years at 90% of the nominal rated power output, 25 years at 80% of the nominal rated power output

Qualifications and Certificates

IEC 61215 Edition 2, IEC 61730 Class A, UL1703, CE, ISO 9001,ISO14000,OHSAS18001

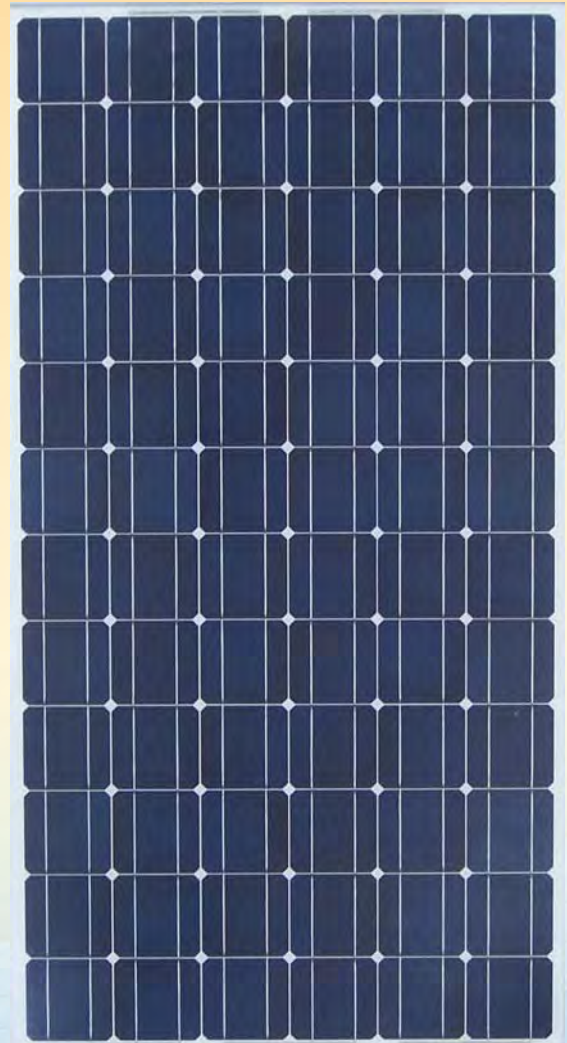

- Qualified, IEC 61215
- Safety limited, IEC 61730
- Periodic Inspection



*Design and specifications are subject to change without notice.

Add: No.555 Shen NanRoad, Xin Zhuang Industrial Zone, Shanghai, P.R. China, 201108

Tel: 86-21-64895099 Fax: 86-21-64898715

http: //www.ssec-solar.com E-mail: webmaster@ssec-solar.com

STC	S-175C	S-180C	S-185C	S-190C	S-195C
Nominal peak power	175W	180W	185W	190W	195W
Open circuit voltage	44.7V	44.9V	45.1V	45.3V	45.6V
Max. power voltage	35.7V	36.0V	36.5V	36.9V	37.4V
Short circuit current	5.30A	5.40A	5.45A	5.53A	5.61A
Max. power current	4.89A	4.99A	5.06A	5.15A	5.22A
module efficiency	13.4%	13.8%	14.2%	14.6%	15.0%
Power output tolerances	±3%				
Max. system voltage	1,000 VDC				
Max.series fuse rating	10A				
Operating temperature	- 40°C to + 85°C				
*Electrical parameters at STC (1,000 W/m ² , 25°C, AM 1.5 according to EN 60904-3)					

NOCT	S-175C	S-180C	S-185C	S-190C	S-195C
Nominal peak power	125W	129W	132W	136W	140W
Open circuit voltage	40.7V	40.9V	41.1V	41.3V	41.5V
Max. power voltage	31.5V	31.8V	32.2V	32.5V	32.9V
Short circuit current	4.29A	4.37A	4.41A	4.48A	4.54A
Max. power current	3.97A	4.06A	4.10A	4.18A	4.25A
NOCT	46°C±2°C				
*Electrical parameters at NOCT (800 W/m ² , 20°C, AM 1.5 according to EN 60904-3)					

Temperature coefficients	
γPm	-0.47%/K
αIsc	0.038%/K
βVoc	-0.34%/K

Mechanical parameters	
Module dimension	1575*826*46(mm)
Weight	16.3kg
Max. wind Load	2400pa
Max. snow Load	5400pa
Cell dimension	125*125
Cell type	72(6*12) / monocrystalline
Packing method	264pcs/20' 616pcs/40'

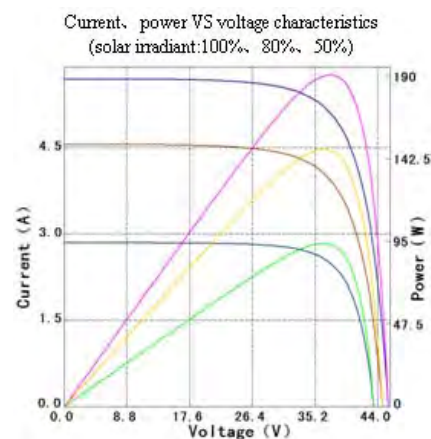
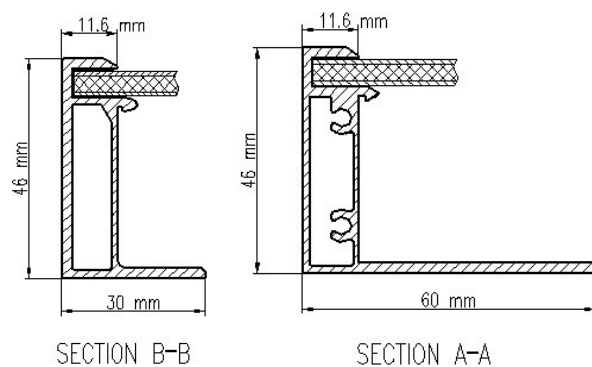
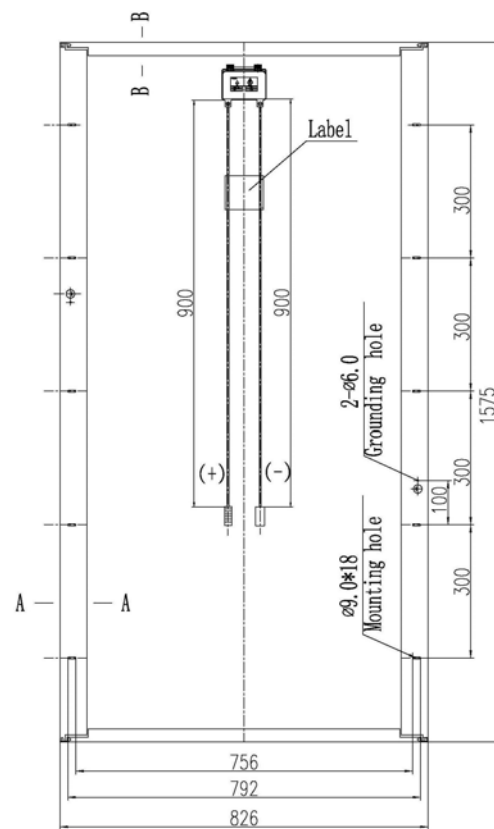

*Design and specifications are subject to change without notice.

Add: No.555 Shen NanRoad, Xin Zhuang Industrial Zone, Shanghai, P.R. China, 201108

Tel: 86-21-64895099 Fax: 86-21-64898715

http: //www.ssec-solar.com E-mail: webmaster@ssec-solar.com



Shanghai Solar Energy S&T Co.,Ltd.